

# APH 400

Adjust the spherical power till the best visual acuity is obtained with the maximum plus power.



## WELCOME TO THE WORLD OF AUTOMATIC REFRACTION



APH 400

AUTOMATIC REFRACTOR



pola



Optometry



# WELCOME TO THE WORLD OF AUTOMATIC REFRACTION

The **APH 400** is an automatic refractor that integrates seamlessly into your existing refraction environment to speed examination and streamline workflow. Featuring state-of-the-art technology, this user-friendly solution will help transform the patient experience and enhance your expertise in the refraction room.

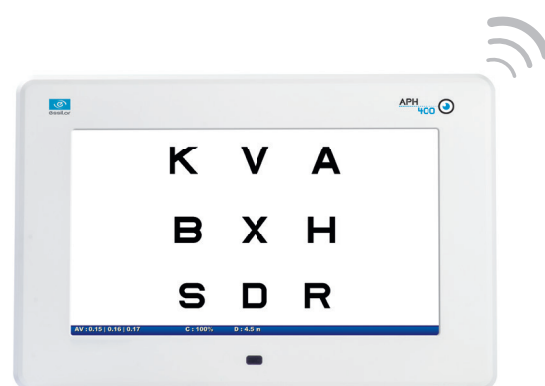

## INTUITIVELY SIMPLE TO USE

- The interface performs all routine manual refraction tasks, instantly adapting to your working methods and processes in every exam situation.
- It's intuitive and immediately simple to use with easily-accessible commands all grouped onto one screen.
- An interactive visual aid is available at the touch of a button for first-time users.



## EASY TO INSTALL

- + Installation is simple - with no wiring required.
- + The APH 400 refractor, screen and tablet are programmed for immediate integration and use via wireless connectivity.

## FASTER REFRACTION PROCESS

- Connected to the refractor head and the screen, the tablet monitors the entire refraction process for faster, more efficient exams.
- By collecting data from a lensmeter or Essilor AKR, the system ensures refraction starts as close as possible to the patient's correction.
- It includes a memory function that stores refraction data enabling you to gain time and more effectively demonstrate the benefits of the new correction.



## A MORE PROFESSIONAL EXPERIENCE

- Wireless connectivity means you can control the entire refraction process from the tablet at a comfortable distance from your patient.
- Ergonomic design and mobile controls enable you to focus more on your patient and less on the technology during the exam.
- The tablet also offers a convenient way to share information and results instantaneously with patient.

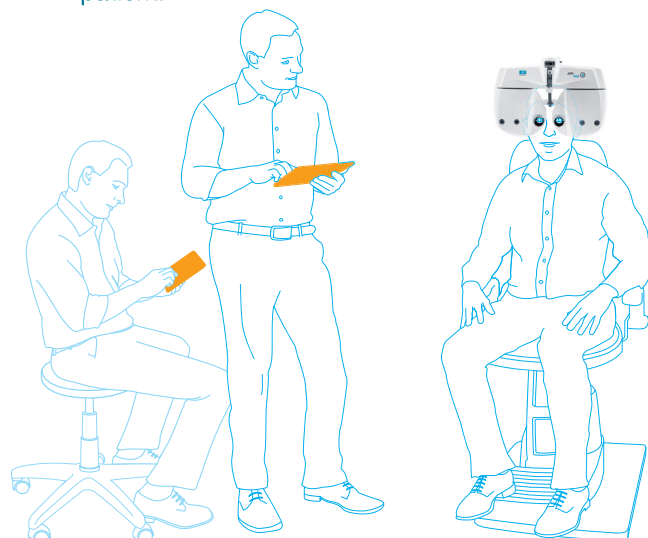

## AN OPEN DATA EXCHANGE SYSTEM

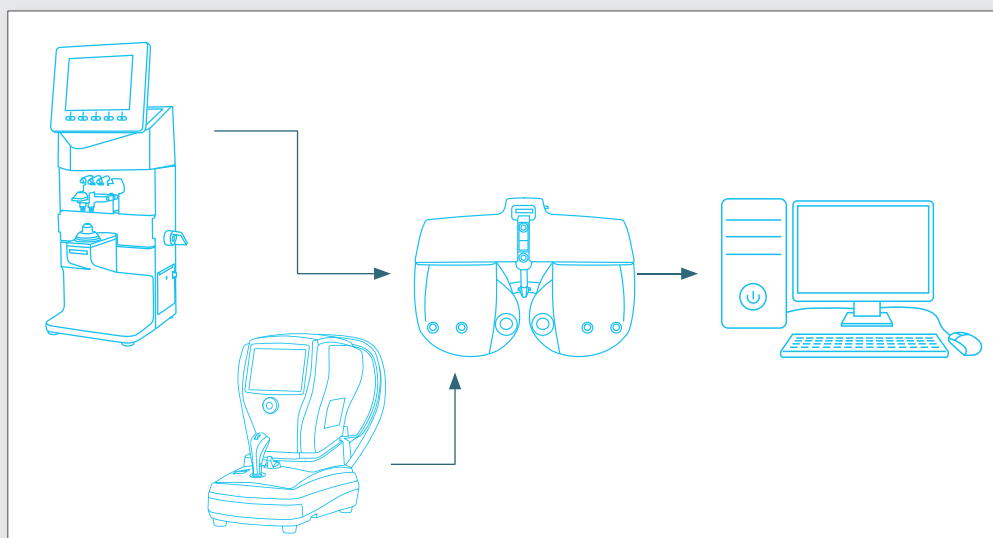

To simplify and speed the examination process, the system can pull in data from an AKR or lensmeter<sup>(1)</sup>.

At the end of refraction, the APH 400 then automatically transfers the refraction results to your Patient Management System (PMS) or Electronic Health Record (EHR)<sup>(1)</sup>.

<sup>(1)</sup> Check the compatibility of devices with manufacturer.

# COMPATIBLE CHART SYSTEMS



CS 400



CS POLA 400

	CS 400	CS POLA 400
<b>SCREEN SIZE</b>	LCD SCREEN 19"	LCD SCREEN 24"
<b>BRIGHTNESS/CONTRAST</b>	250 Cd/m <sup>2</sup> - Contrast from 100% to 1%	250 Cd/m <sup>2</sup> - Contrast from 100% to 1%
<b>PROJECTION DISTANCE</b>	2 to 6 m	2 to 8 m
<b>TESTS</b>	Letters, Numerals, Snellen, Landolt rings, 4 Ranges for children.	Letters, Numerals, Snellen, Landolt rings, 4 Ranges for children.
Optotypes		
Visual functions	ETDRS scale with scores at 1m, 2m and 4m, Parent's test, Dots tests, Jackson's cross, Worth's test, Schober's test, Depth perception test, Coincidence test, Phoria test, Fixation point, Ishihara tests, Red/Green test.	Parent's test, Malett's test, MKH tests (cyclophoria, stereo etc.), Dots tests, Jackson's cross, Worth's test, Schober's test, Depth perception test (polarised), Coincidence test, Aniseikonia (polarized), Phoria test (polarised), Fixation point, Ishihara tests, Binocular balance (polarised).
<b>DIMENSIONS AND WEIGHT</b>	430(W) x 370(H) x 70(D) mm - 6 kg	695(W) x 465(H) x 70(D) mm - 8 kg
<b>POWER SUPPLY</b>	100 - 240 V AC 50/60 HZ CE marking conformity	100 - 240 V AC 50/60 HZ CE marking conformity

	APH 400	AUXILIARY LENS	
<b>MEASURING RANGE</b>		Red/green filter	•
Pupillary distance	52 ~ 80 mm	Polarizing filter	•
Sphere	-19.00 D ~ 16.75 D (0.25 D / 0.5 D / 1.0 D / 3.0 D)	Prism	6 Δ / 10 Δ U
Cylinder	-6.00 D ~ + 6.00 D (0.25 D)	Rod Maddox (Horiz./vertic.)	Red
Axis	0° ~ 180° (1° / 5°)	Lens for retinoscopy	•
Prism	0 ~ 20 Δ (1 Δ)	Cross cylinder (±0.50D)	•
<b>CONVERGENCE (NEAR-VISION)</b>	•	Pin hole	•
<b>DIMENSIONS AND WEIGHT</b>	360(W) x 280(H) x 80(D) mm - 3.8 kg	<b>POWER SUPPLY</b>	DC 24 V 60 W 50 / 60 Hz CE marking conformity

## PRODUCT FUNCTIONS



Measurement range - sphere and cylinder



Measurement range - Prism



Polarisation



Cross cylinders



Wireless data transfer



Instruments Division  
64 bis, avenue Aubert  
94306 Vincennes Cedex France  
Tel: 33 (0)1 72 94 71 00  
Fax: 33 (0)1 72 94 70 27  
www.essilor-instruments.com

Your contact: